

# Table Saw Workstation

## Materials

A Side Rails (4)	$\frac{3}{4}$ x 2 $\frac{1}{2}$ - 17 $\frac{1}{2}$	Q Side Stiles (4)	$\frac{3}{4}$ x 2 $\frac{1}{2}$ - 30
B Side Stiles (4)	$\frac{3}{4}$ x 2 $\frac{1}{2}$ - 16 $\frac{7}{8}$	R Side Panels (2)	22 $\frac{1}{2}$ x 25 $\frac{1}{2}$ - $\frac{1}{2}$ Ply.
C Side Panels (2)	17 $\frac{1}{2}$ x 12 $\frac{3}{8}$ - $\frac{1}{2}$ Ply.	S Subtop/Bottom (1)	26 x 26 - $\frac{3}{4}$ Ply.
D Back Rails (2)	$\frac{3}{4}$ x 2 $\frac{1}{2}$ - 21 $\frac{5}{8}$	T Front/Back Stiles (4)	$\frac{3}{4}$ x 2 $\frac{1}{2}$ - 30
E Back Stiles (2)	$\frac{3}{4}$ x 2 $\frac{1}{2}$ - 16 $\frac{7}{8}$	U Front/Back Rails (3)	$\frac{3}{4}$ x 1 $\frac{1}{2}$ - 21 $\frac{1}{8}$
F Back Panel (1)	21 $\frac{5}{8}$ x 12 $\frac{3}{8}$ - $\frac{1}{2}$ Ply.	V Door (1)	19 $\frac{3}{8}$ x 26 $\frac{7}{8}$ - $\frac{3}{4}$ Ply.
G Subtop/Bottom (2)	21 $\frac{1}{2}$ x 26 - $\frac{3}{4}$ Ply.	W Edging	$\frac{3}{4}$ x $\frac{3}{4}$ - 9 Ln. Ft.
H Lower Rail (1)	$\frac{3}{4}$ x 2 $\frac{1}{2}$ - 27	X Door Stop (1)	$\frac{3}{4}$ x 2 $\frac{3}{4}$ - 28 $\frac{1}{2}$
I Top (1)	21 $\frac{3}{4}$ x 26 $\frac{1}{2}$ - $\frac{3}{4}$ Ply.	Y Outfeed Top (1)	26 $\frac{1}{2}$ x 38 $\frac{1}{2}$ - $\frac{3}{4}$ Ply.
J Edging	$\frac{3}{4}$ x $\frac{3}{4}$ - 9 Ln. Ft.	Z Edging	$\frac{3}{4}$ x $\frac{3}{4}$ - 12 Ln. Ft.
K Fronts/Backs (4)	$\frac{3}{4}$ x 5 $\frac{1}{2}$ - 24	AA Access Plate (1)	16 x 16 - $\frac{3}{4}$ Ply.
L Sides (4)	$\frac{3}{4}$ x 5 $\frac{1}{2}$ - 20	BB Pads (4)	(Custom size to fit tablesaw)
M Bottoms (2)	19 $\frac{1}{2}$ x 24 - $\frac{1}{4}$ Ply.	CC Base	6 $\frac{1}{4}$ x 32 - $\frac{3}{4}$ Ply.
N False Fronts (2)	5 $\frac{1}{2}$ x 25 $\frac{1}{2}$ - $\frac{3}{4}$ Ply.	DD Face	5 x 32 - $\frac{1}{2}$ Ply.
O Edging	$\frac{3}{4}$ x $\frac{3}{4}$ - 11 Ln. Ft.	EE Braces	3 $\frac{1}{2}$ x 3 $\frac{1}{2}$ - $\frac{1}{2}$ Ply.
P Side Rails (4)	$\frac{3}{4}$ x 2 $\frac{1}{2}$ - 22 $\frac{1}{2}$	FF Cover	5 x 5 $\frac{15}{16}$ - $\frac{1}{2}$ Ply.

$\frac{3}{4}$ " x 6" x 96"



$\frac{3}{4}$ " x 6" x 96"

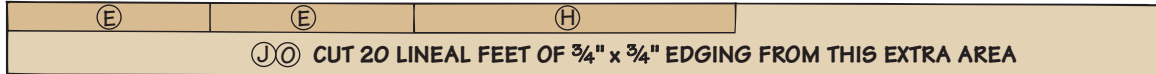

$\frac{1}{2}$ " x 6" x 96" (TWO BOARDS)



$\frac{3}{4}$ " x 6" x 96"

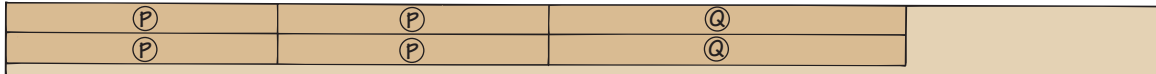

$\frac{3}{4}$ " x 6" x 96"



$\frac{3}{4}$ " x 8" x 96"



48" x 96" - 1/2" PLYWOOD

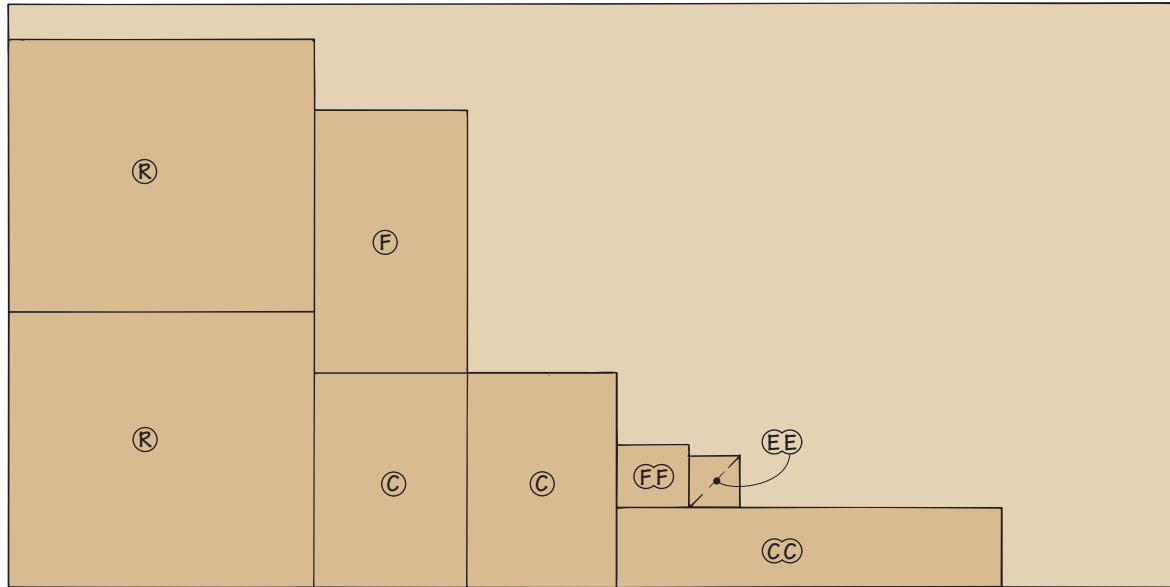

48" x 96" - 3/4" PLYWOOD

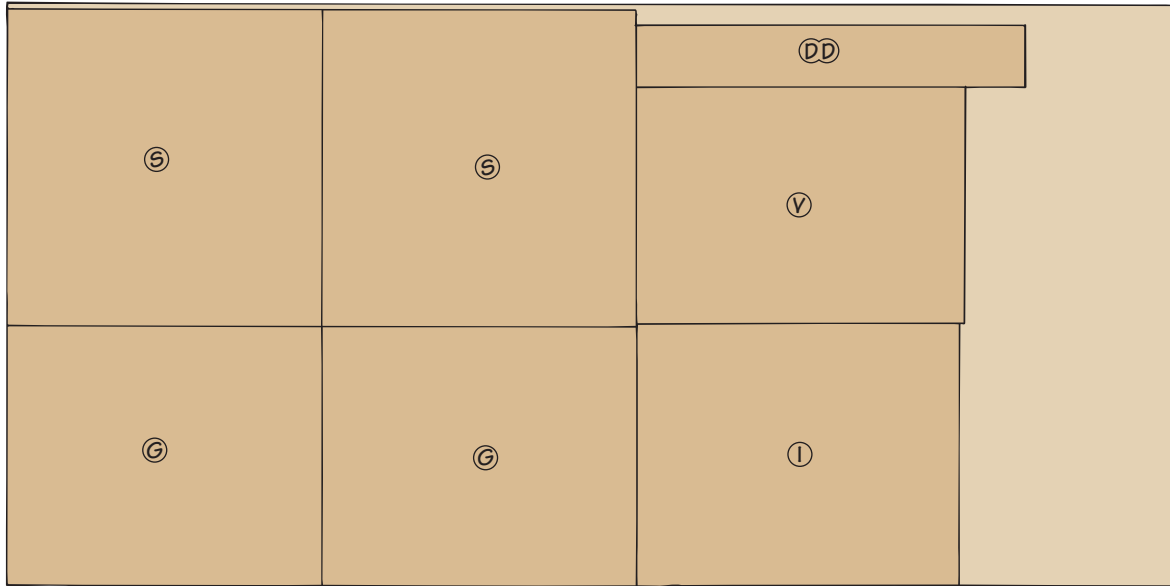

48" x 96" - 3/4" PLYWOOD

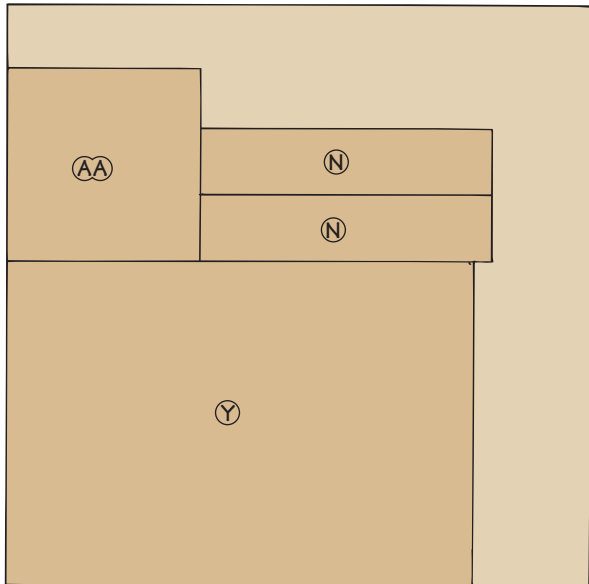

24" x 48" - 1/4" PLYWOOD

